

# FLOORPLAN VILLA RISSEN HAMBURG



VILLA RISSEN  
HAMBURG







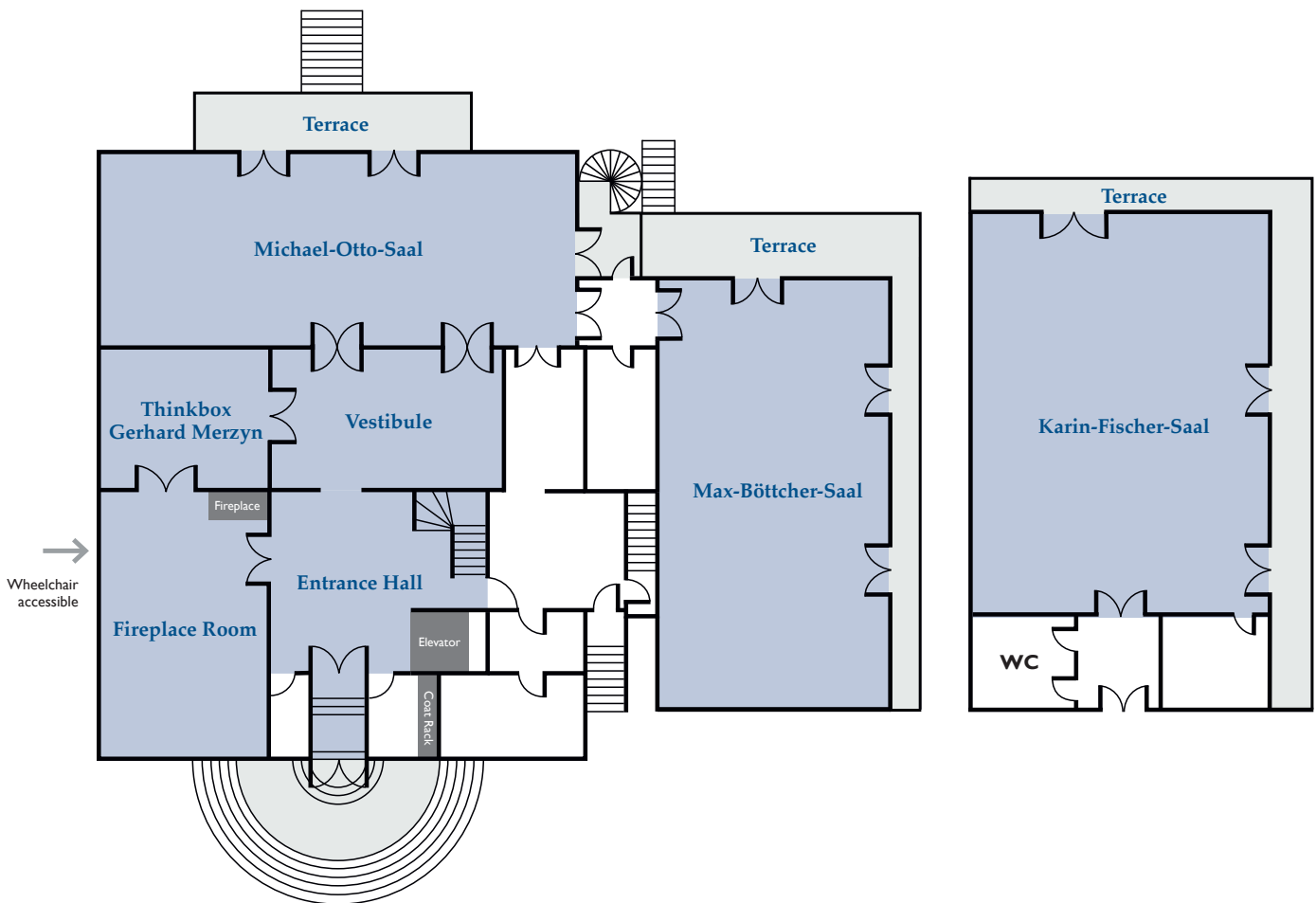

## Floorplan

### Ground Floor



**Room Size** **Height** **Seating**

									
			Class	Conference	U-Shape	Circle	Reception	Banquet	Theatre
<b>Entrance Hall</b>	33 sqm	2,80 m	-	-	-	-	20	-	-
<b>Vestibule</b>	33 sqm	2,80 m	-	-	-	-	20	16	-
<b>Thinkbox GM</b>	29 sqm	2,80 m	12	16	-	20	20	16	24
<b>Fireplace Room</b>	55 sqm	2,80 m	20	20	20	26	40	24	50
<b>Max-Böttcher-Saal</b>	99 sqm	2,80 m	40	32	24	40	150	64	120
<b>Karin-Fischer-Saal</b>	122 sqm	3,20 m	46	50	30	50	200	80-100	180
<b>Michael-Otto-Saal</b>	120 sqm	2,60 m	46	50	30	50	200	80-100	180



## Floorplan



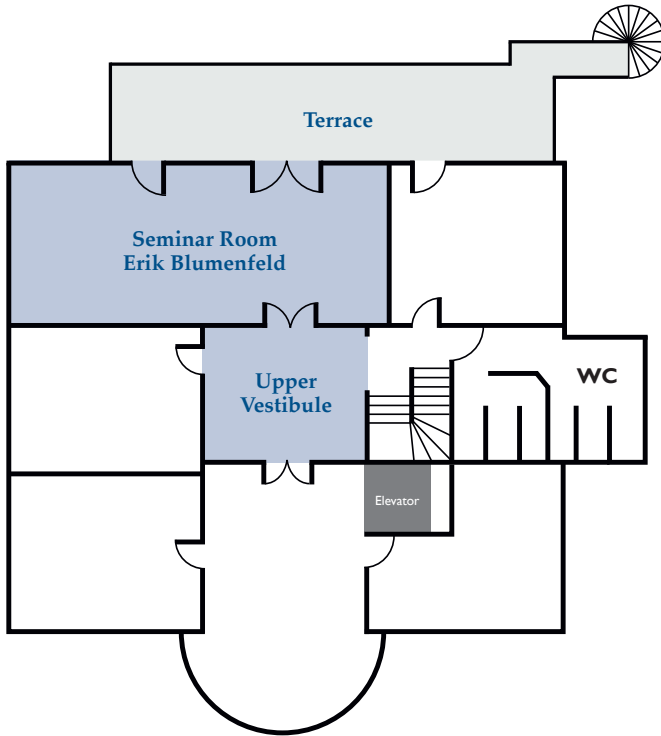

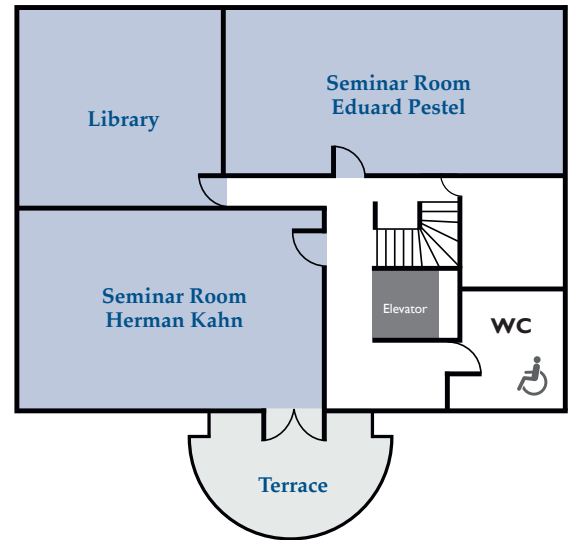

### First Floor



### Top Floor



Room Size Hight Seating

	Room Size	Hight	Seating					
								
			Class	Conference	U-Shape	Circle	Banquet	Theatre
<b>Seminar Room Erik Blumenfeld</b>	53 sqm	3,00 m	20	18	23	20	18	40
<b>Seminar Room Eduard Pestel</b>	40 sqm	3,50 m	16	24	16	22	-	-
<b>Library</b>	27 sqm	3,50 m	-	8	-	8	-	-
<b>Seminar Room Herman Kahn</b>	54 sqm	3,50 m	24	20	22	22	-	50



VILLA RISSEN  
HAMBURG